



PCB机箱安装系列

汽车保险丝座

PCB Box AUTO Fuse Holder

编号: SL703E

电流:10A 电压:AC250V

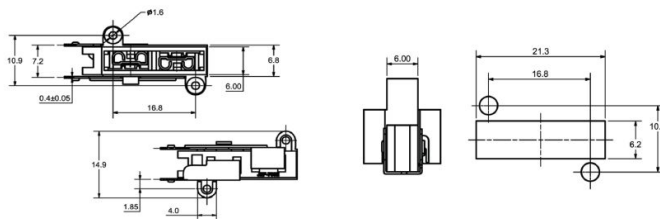

编号: SL703C

电流:6.3A 电压:AC250V

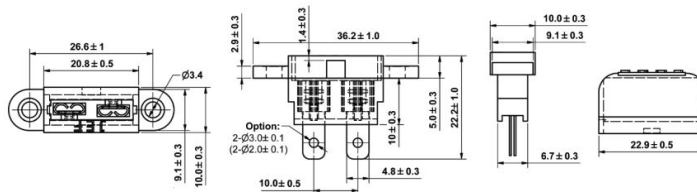

编号: SL703D

电流:10A 电压:AC250V

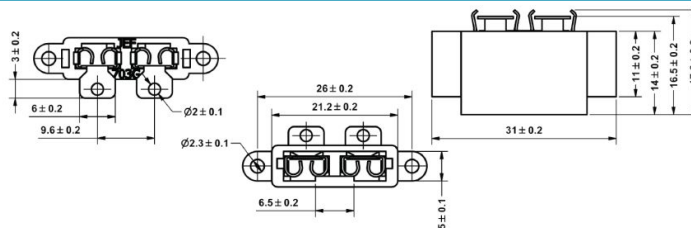

编号: SL703 FA

电流:6.3A 电压:AC250V

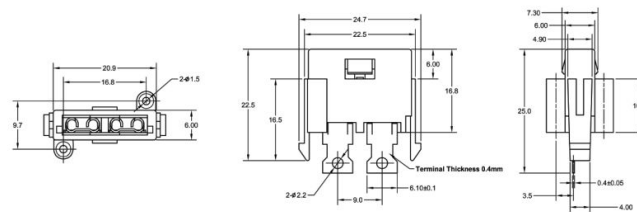

编号: SL703FC

电流:6.3A 电压:AC250V

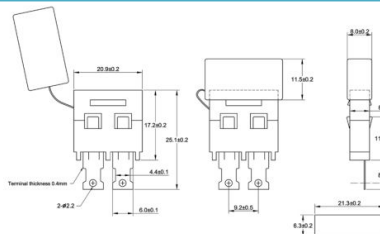

编号: SL703H

电流:6.3A 电压:AC250V

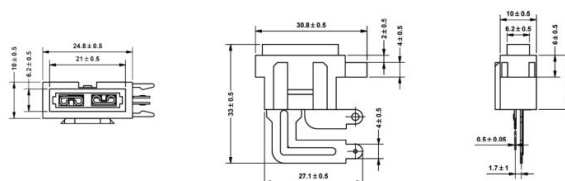



编号: SL703E

电流:10A 电压:AC250V

RoHS

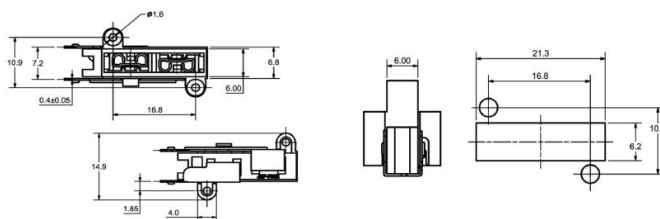

编号: SL703C

电流:6.3A 电压:AC250V

RoHS

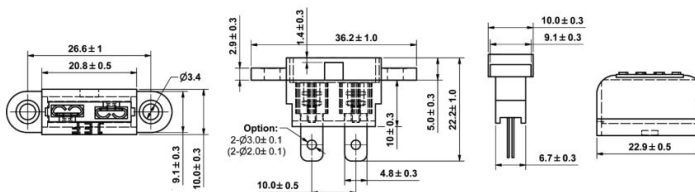

编号: SL703D

电流:10A 电压:AC250V

RoHS

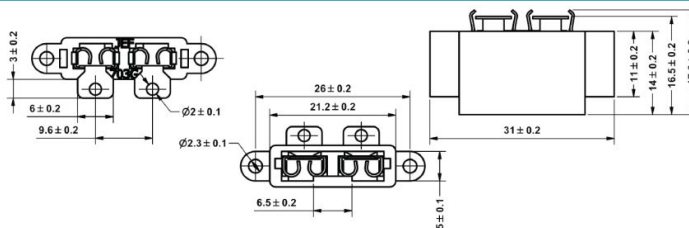

编号: SL703 FA

电流:6.3A 电压:AC250V

RoHS

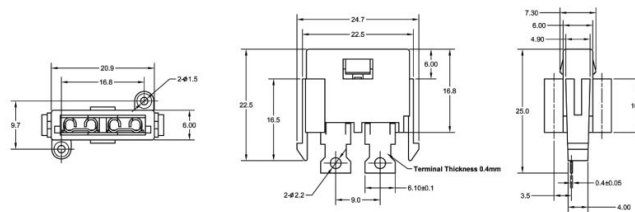

编号: SL703FC

电流:6.3A 电压:AC250V

RoHS

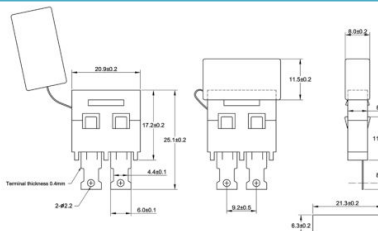

编号: SL703H

电流:6.3A 电压:AC250V



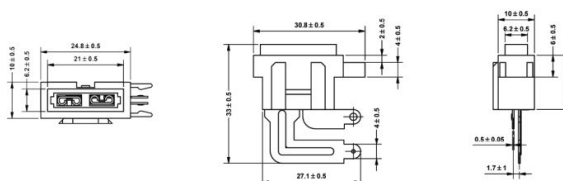





RoHS

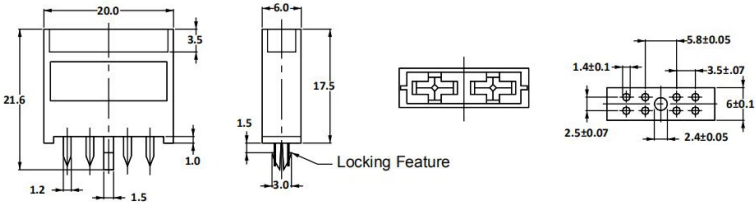

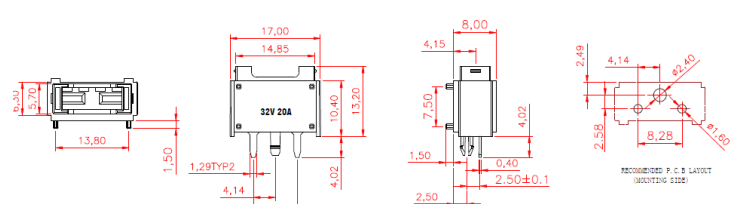

PCB安装系列

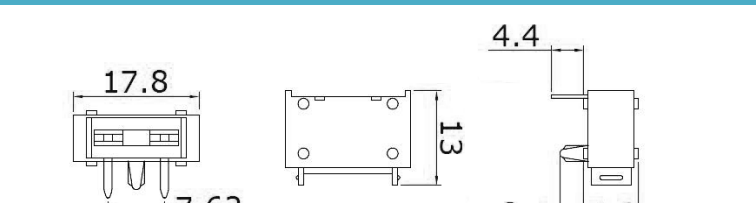

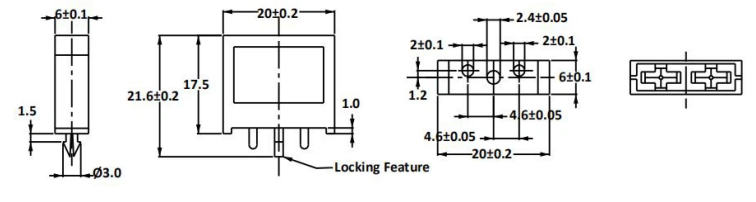



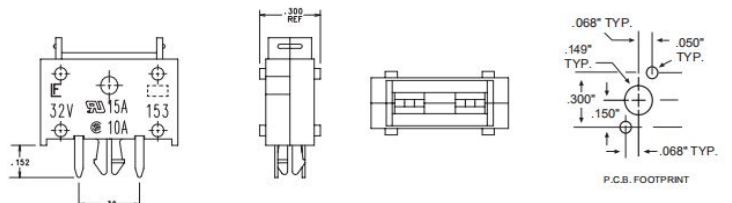

汽车保险丝座 PCB AUTO Fuse Holder

<p>编号: 178.6165</p> 	<p>电流:30A 电压:AC250V  </p>  <p>Locking Feature</p>
<p>编号: SL1538</p> 	<p>电流:10-15A 电压:125V  </p> 
<p>编号: SL1533</p> 	<p>电流:20A 电压:AC125V  </p>  <p>32V 20A</p> <p>1,29TYP2</p> <p>RECOMMENDED P.C.B LAYOUT (INDICATING CODE)</p>
<p>编号: SL1537</p> 	<p>电流:10A 电压:AC125V  </p> 
<p>编号: SL612</p> 	<p>电流:30A 电压:125V </p>  <p>Auto blade fuse</p>
<p>编号: SL-Z-06.087</p> 	<p> </p>  <p>Locking Feature</p>

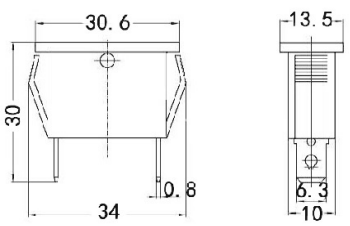

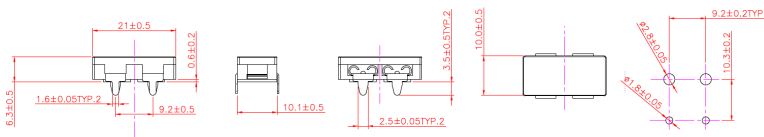
PCB安装系列

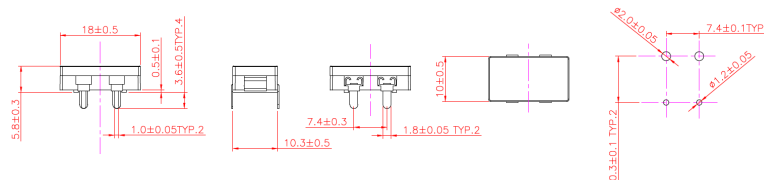
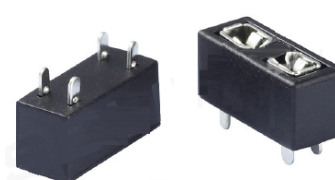
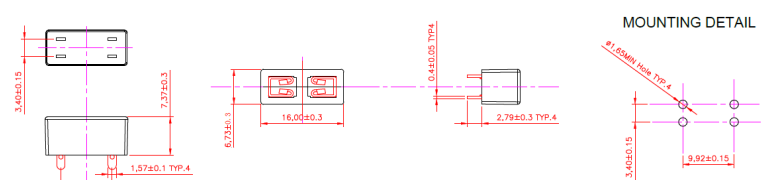
汽车保险丝座 PCB AUTO Fuse Holder

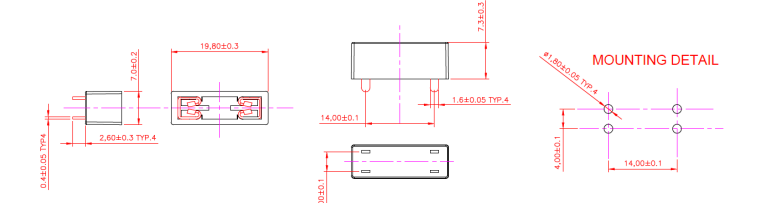
<p>编号: 01530008</p> 	<p>电流:20A 电压:32V</p>  <p>RoHS</p>
<p>编号: SL11</p> 	<p>电流:5-20A 电压:AC250V</p>  <p>RoHS</p>
<p>编号: SL25A</p> 	<p>电流:30A 电压:AC125V</p>  <p>RoHS</p>
<p>编号: SL26A</p> 	<p>电流:20A 电压:AC125V</p>  <p>RoHS</p>
<p>编号: SL506B</p> 	<p>电流:30A 电压:AC125V</p>  <p>RoHS</p>
<p>编号: SL506A</p> 	<p>电流:30A 电压:AC125V</p>  <p>RoHS</p>



编号: SL506K

电流:10A 电压:AC250V

RoHS

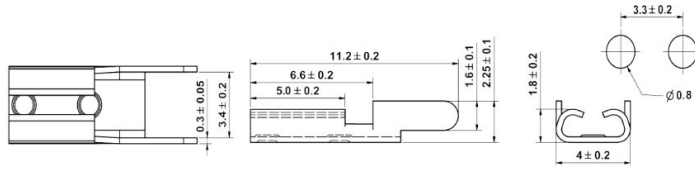

编号: SL506P

电流:6.3A 电压:AC250V

RoHS

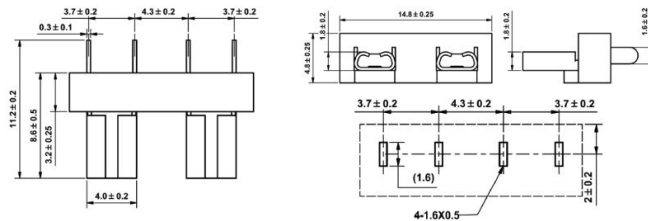
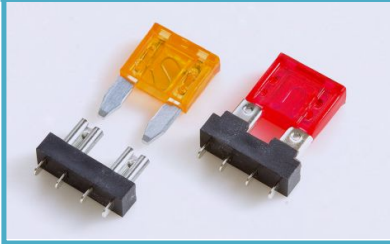

编号: SL506H

电流:10A 电压:AC250V

RoHS

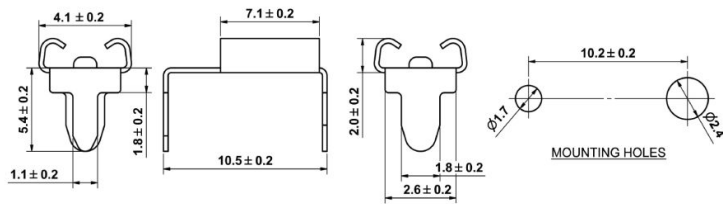
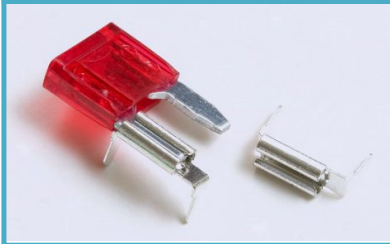

编号: SL506BA

电流:6.3A 电压:AC250V

RoHS

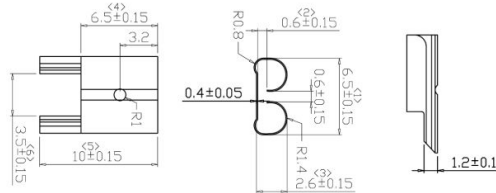

编号: SL506J

电流:6.3A 电压:AC250V

RoHS

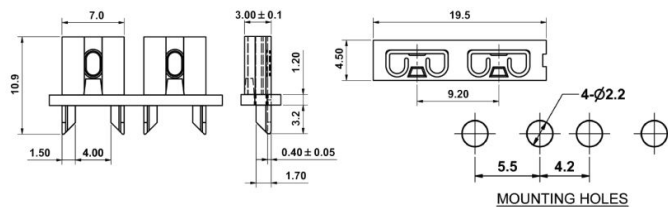
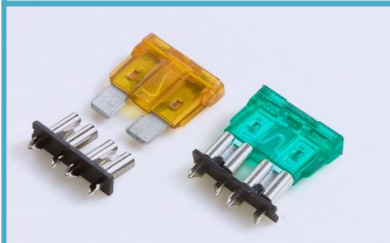

编号: SL506Q

电流:6.3A 电压:AC250V

RoHS

